

T_B^{aper} ore V-pulleys

SPA-1

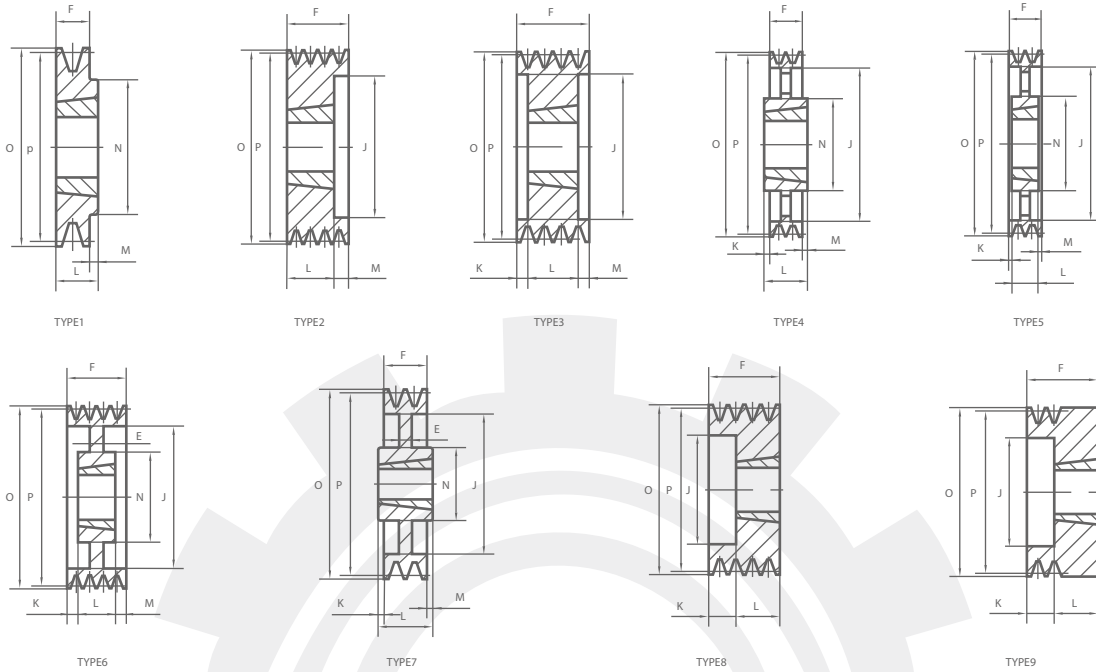

PART NO.	NO.OF PD GROOVES	O.D	TYPE	BUSH	MAX NO.	E BORE	F	J	K	L	M	N	
SPA 63-01	1	63.0	68.5	1	1008	28	—	20	—	—	22	2	56
SPA 67-01	1	67.0	72.5	1	1108	28	—	20	—	—	22	2	62
SPA 71-01	1	71.0	76.5	1	1108	28	—	20	—	—	22	2	62
SPA 75-01	1	75.0	80.5	1	1108	28	—	20	—	—	22	2	62
SPA 80-01	1	80.0	85.5	1	1210	32	—	20	—	—	25	5	75
SPA 85-01	1	85.0	90.5	1	1210	32	—	20	—	—	25	5	75
SPA 90-01	1	90.0	95.5	1	1210	32	—	20	—	—	25	5	75
SPA 95-01	1	95.0	100.5	1	1210	32	—	20	—	—	25	5	75
SPA100-01	1	100.0	105.5	1	1610	42	—	20	—	—	25	5	80
SPA106-01	1	106.0	111.5	1	1610	42	—	20	—	—	25	5	80
SPA112-01	1	112.0	117.5	1	1610	42	—	20	—	—	25	5	80
SPA118-01	1	118.0	123.5	1	1610	42	—	20	—	—	25	5	80
SPA125-01	1	125.0	130.5	1	1610	42	—	20	—	—	25	5	80
SPA132-01	1	132.0	137.5	1	1610	42	—	20	—	—	25	5	80
SPA140-01	1	140.0	145.5	1	1610	42	—	20	—	—	25	5	80
SPA150-01	1	150.0	155.5	1	1610	42	—	20	—	—	25	5	80
SPA160-01	1	160.0	165.5	1	1610	42	—	20	—	—	25	5	80
SPA170-01	1	170.0	175.5	1	1610	42	—	20	—	—	25	5	80
SPA180-01	1	180.0	185.5	1	1610	42	—	20	—	—	25	5	80
SPA190-01	1	190.0	195.5	1	1610	42	—	20	—	—	25	5	80
SPA200-01	1	200.0	205.5	7	2012	50	10	20	165	—	32	12	100
SPA224-01	1	224.0	229.5	7	2012	50	10	20	189	—	32	12	100
SPA250-01	1	250.0	255.5	7	2012	50	10	20	215	6	32	6	100
SPA280-01	1	280.0	285.5	7	2012	50	10	20	245	—	32	12	100
SPA315-01	1	315.0	320.5	4	2012	50	—	20	280	—	32	12	100
SPA355-01	1	355.0	360.5	4	2012	50	—	20	320	—	32	12	100
SPA400-01	1	400.0	405.5	4	2012	50	—	20	365	—	32	12	100
SPA450-01	1	450.0	455.5	4	2012	50	—	20	415	—	32	12	100
SPA500-01	1	500.0	505.5	4	2517	60	—	20	465	—	45	25	120
SPA630-01	1	630.0	635.5	4	2517	60	—	20	595	—	45	25	120

T_{aper} B_{ore} V-pulleys

SPA-2

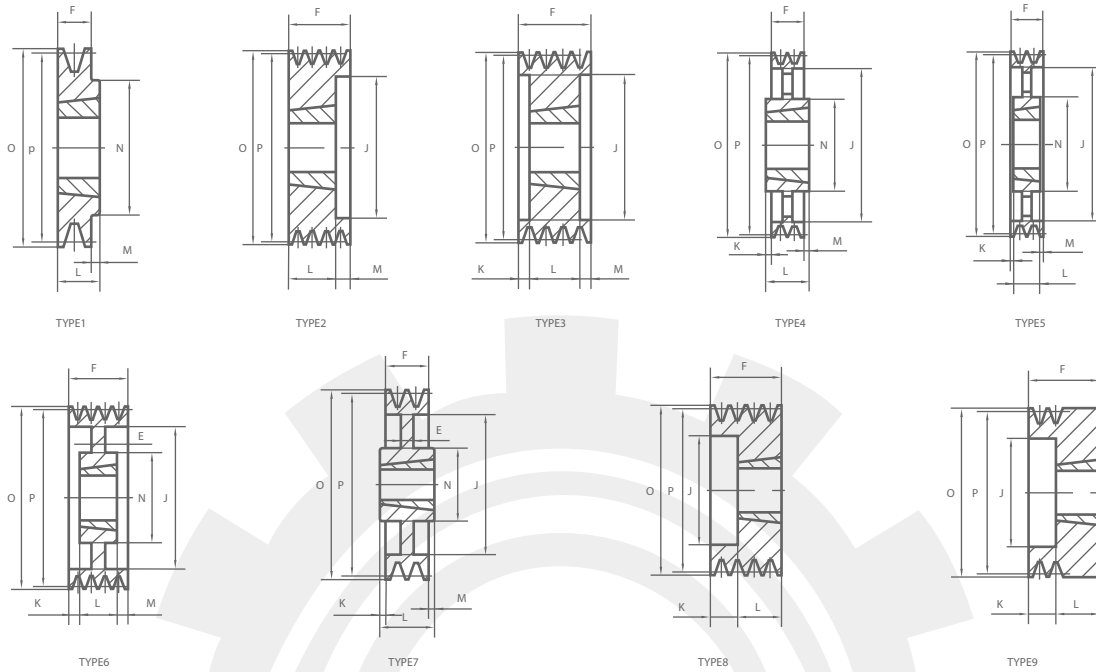

PART NO.	NO.OF PD GROOVES	O.D	TYPE	BUSH	MAX NO.	E BORE	F	J	K	L	M	N	
SPA 63-02	2	63.0	68.5	8	1008	28	—	35	36	13	22	—	—
SPA 67-02	2	67.0	72.5	8	1108	28	—	35	37	13	22	—	—
SPA 71-02	2	71.0	76.5	8	1108	28	—	35	40	13	22	—	—
SPA 75-02	2	75.0	80.5	8	1108	28	—	35	44	13	22	—	—
SPA 80-02	2	80.0	85.5	8	1210	32	—	35	47	10	25	—	—
SPA 85-02	2	85.0	90.5	8	1210	32	—	35	50	10	25	—	—
SPA 90-02	2	90.0	95.5	8	1610	42	—	35	60	10	25	—	—
SPA 95-02	2	95.0	100.5	8	1610	42	—	35	64	10	25	—	—
SPA100-02	2	100.0	105.5	8	1610	42	—	35	70	10	25	—	—
SPA106-02	2	106.0	111.5	8	1610	42	—	35	76	10	25	—	—
SPA112-02	2	112.0	117.5	8	1610	42	—	35	80	10	25	—	—
SPA118-02	2	118.0	123.5	8	1610	42	—	35	86	10	25	—	—
SPA125-02	2	125.0	130.5	8	1610	42	—	35	90	10	25	—	—
SPA132-02	2	132.0	137.5	8	2012	50	—	35	98	3	32	—	—
SPA140-02	2	140.0	145.5	8	2012	50	—	35	106	3	32	—	—
SPA150-02	2	150.0	155.5	8	2012	50	—	35	116	3	32	—	—
SPA160-02	2	160.0	165.5	8	2012	50	15	35	125	3	32	—	—
SPA170-02	2	170.0	175.5	8	2012	50	15	35	135	3	32	—	—
SPA180-02	2	180.0	185.5	6	2012	50	15	35	148	1.5	32	1.5	100
SPA190-02	2	190.0	195.5	6	2012	50	15	35	158	1.5	32	1.5	100
SPA200-02	2	200.0	205.5	7	2517	60	15	35	165	5	45	5	120
SPA224-02	2	224.0	229.5	7	2517	60	15	35	189	—	45	10	120
SPA250-02	2	250.0	255.5	7	2517	60	20	35	215	5	45	5	120
SPA280-02	2	280.0	285.5	7	2517	60	20	35	245	—	45	10	120
SPA315-02	2	315.0	320.5	4	2517	60	—	35	280	—	45	10	120
SPA355-02	2	355.0	360.5	4	2517	60	—	35	320	—	45	10	120
SPA400-02	2	400.0	405.5	4	2517	60	—	35	365	—	45	10	120
SPA500-02	2	500.0	505.5	4	2517	60	—	35	465	—	45	10	120
SPA560-02	2	560.0	565.5	4	3020	75	—	35	525	—	51	16	150
SPA630-02	2	630.0	635.5	4	3020	75	—	35	595	—	51	16	150

T_B^{aper} ore V-pulleys

SPA-3

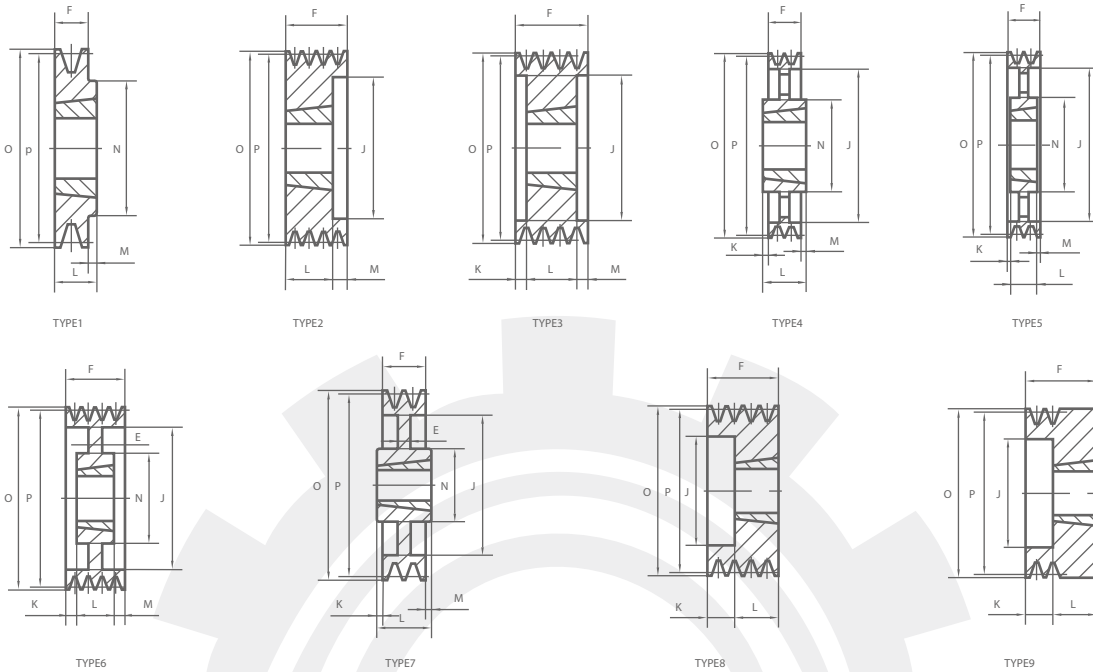

PART NO.	NO.OF P.D GROOVES	O.D	TYPE	BUSH	MAX NO.	E BORE	F	J	K	L	M	N	
SPA 71-03	3	71.0	76.5	8	1108	28	—	50	40	28	22	—	—
SPA 75-03	3	75.0	80.5	8	1108	32	—	50	44	28	22	—	—
SPA 80-03	3	80.0	85.5	8	1210	32	—	50	47	25	25	—	—
SPA 85-03	3	85.0	90.5	8	1210	32	—	50	50	25	25	—	—
SPA 90-03	3	90.0	95.5	8	1610	42	—	50	60	25	25	—	—
SPA 95-03	3	95.0	100.5	8	1610	42	—	50	64	25	25	—	—
SPA100-03	3	100.0	105.5	2	1610	42	—	50	70	—	25	25	—
SPA106-03	3	106.0	111.5	2	1610	42	—	50	76	—	25	25	—
SPA112-03	3	112.0	117.5	8	2012	50	—	50	83	18	32	—	—
SPA118-03	3	118.0	123.5	2	2012	50	—	50	86	—	32	18	—
SPA125-03	3	125.0	128.5	2	2012	50	—	50	92	—	32	18	—
SPA132-03	3	132.0	137.5	2	2012	50	—	50	98	—	32	18	—
SPA140-03	3	140.0	145.5	8	2517	60	—	50	106	5	45	—	—
SPA150-03	3	150.0	155.5	8	2517	60	—	50	116	5	45	—	—
SPA160-03	3	160.0	165.5	8	2517	60	—	50	126	5	45	—	—
SPA170-03	3	170.0	175.5	8	2517	60	—	50	138	5	45	—	—
SPA180-03	3	180.0	185.5	8	2517	60	—	50	146	5	45	—	—
SPA190-03	3	190.0	195.5	8	2517	60	—	50	158	5	45	—	—
SPA200-03	3	200.0	205.5	6	2517	60	20	50	165	2.5	45	2.5	120
SPA224-03	3	224.0	229.5	6	2517	60	20	50	189	2.5	45	2.5	120
SPA250-03	3	250.0	255.5	6	2517	60	20	50	215	2.5	45	2.5	120
SPA280-03	3	280.0	285.5	6	2517	60	20	50	245	2.5	45	2.5	120
SPA315-03	3	315.0	320.5	7	3020	75	25	50	280	0.5	51	0.5	150
SPA355-03	3	355.0	360.5	4	3020	75	—	50	320	0.5	51	0.5	160
SPA400-03	3	400.0	405.5	4	3020	75	—	50	365	0.5	51	0.5	150
SPA450-03	3	450.0	455.5	4	3020	75	—	50	415	0.5	51	0.5	150
SPA500-03	3	500.0	505.5	4	3020	75	—	50	465	0.5	51	0.5	150
SPA560-03	3	560.0	565.5	4	3020	75	—	50	525	0.5	51	0.5	150
SPA630-03	3	630.0	635.5	4	3020	75	—	50	595	0.5	51	0.5	150
SPA800-03	3	800.0	805.5	4	3535	90	—	50	765	19.5	89	19.5	170
SPA1000-03	3	1000.0	1005.5	4	3535	90	—	50	965	195	89	19.5	178

T_B^{aper} ore V-pulleys

SPA-4

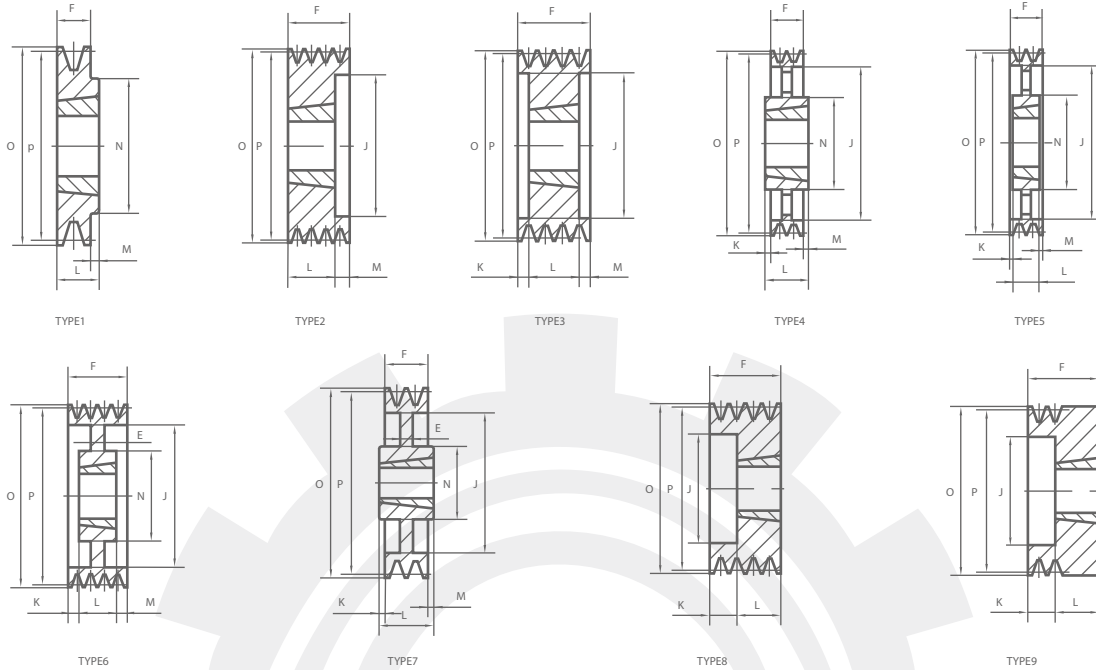

PART NO.	NO.OF PD GROOVES	O.D	TYPE	BUSH	MAX NO.	E BORE	F	J	K	L	M	N	
SPA 90-04	4	90.0	95.5	3	1615	42	—	65	64	13.5	38	13.5	—
SPA 95-04	4	95.0	100.5	3	1615	42	—	65	64	13.5	38	13.5	—
SPA100-04	4	100.0	105.5	2	1615	42	—	65	70	-	38	27	—
SPA106-04	4	106.0	111.5	8	2012	50	—	65	76	33	32	—	—
SPA112-04	4	112.0	117.5	8	2012	50	—	65	80	33	32	—	—
SPA118-04	4	118.0	123.5	2	2012	50	—	65	86	—	32	33	—
SPA125-04	4	125.0	130.5	2	2012	50	—	65	92	—	32	33	—
SPA132-04	4	132.0	137.5	2	2517	60	—	65	98	—	45	20	—
SPA140-04	4	140.0	145.5	2	2517	60	—	65	106	—	45	20	—
SPA150-04	4	150.0	155.5	2	2517	60	—	65	116	—	45	20	—
SPA160-04	4	160.0	165.5	2	2517	60	—	65	126	—	45	20	—
SPA170-04	4	170.0	175.5	2	2517	60	—	65	138	—	45	20	—
SPA180-04	4	180.0	185.5	2	2517	60	—	65	146	—	45	20	—
SPA190-04	4	190.0	195.5	2	2517	60	—	65	158	—	45	20	—
SPA200-04	4	200.0	205.5	2	3020	75	—	65	165	—	51	14	—
SPA224-04	4	224.0	229.5	2	3020	75	—	65	189	—	51	14	—
SPA250-04	4	250.0	255.5	6	3020	75	10	65	215	7	51	7	150
SPA280-04	4	280.0	285.5	6	3020	75	10	65	245	7	51	7	150
SPA315-04	4	315.0	320.5	6	3020	75	10	65	280	7	51	7	150
SPA355-04	4	355.0	360.5	5	3020	75	—	65	320	7	51	7	150
SPA400-04	4	400.0	405.5	5	3020	75	—	65	365	7	51	7	150
SPA450-04	4	450.0	455.5	5	3020	75	—	65	415	7	51	7	150
SPA500-04	4	500.0	505.5	5	3020	75	—	65	465	7	51	7	150
SPA560-04	4	560.0	565.5	4	3535	90	—	65	525	12	89	12	170
SPA630-04	4	630.0	635.5	4	3535	90	—	65	595	12	89	12	170
SPA800-04	4	800.0	805.5	4	3535	90	—	65	765	12	89	12	170
SPA1000-04	4	1000.0	1005.5	4	4040	100	—	65	965	18.5	102	18.5	216

T_B^{aper} ore V-pulleys

SPA-5

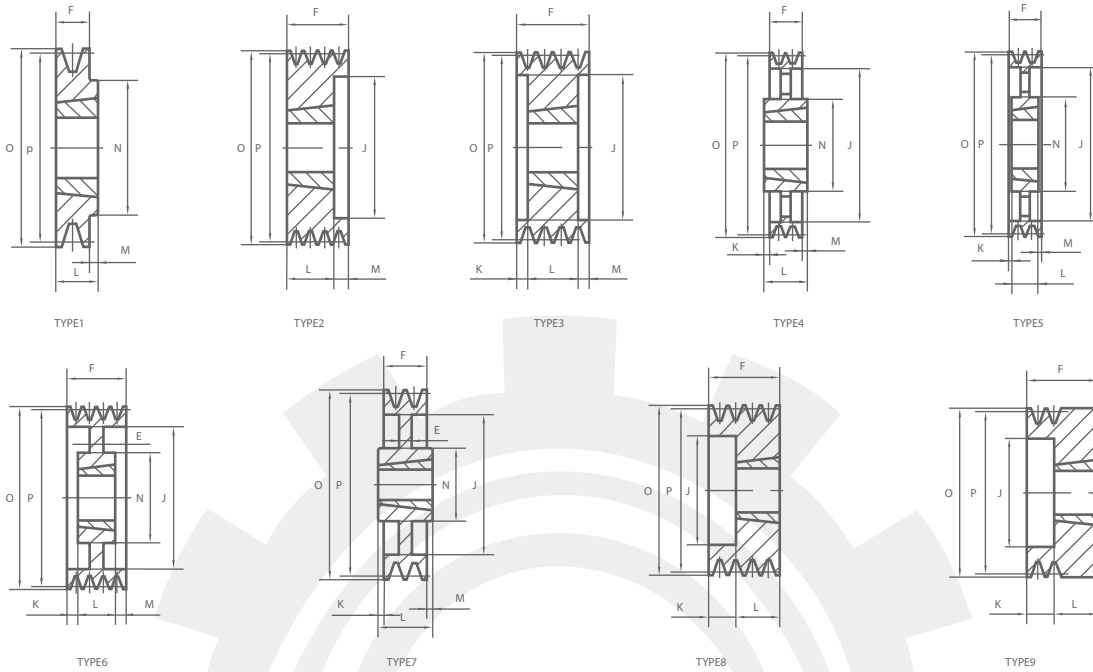

PART NO.	NO.OF PD GROOVES	O.D	TYPE	BUSH	MAX NO.	E BORE	F	J	K	L	M	N	
SPA100-05	5	100.0	105.5	2	1615	42	—	80	70	—	38	42	—
SPA106-05	5	106.0	111.5	8	2012	50	—	80	76	48	32	—	—
SPA112-05	5	112.0	117.5	8	2012	50	—	80	80	48	32	—	—
SPA118-05	5	118.0	123.5	2	2012	50	—	80	86	—	32	48	—
SPA125-05	5	125.0	130.5	3	2012	50	—	80	92	24	32	24	—
SPA132-05	5	132.0	137.5	3	2517	60	—	80	98	17.5	45	17.5	—
SPA140-05	5	140.0	145.5	3	2517	60	—	80	106	17.5	45	17.5	—
SPA150-05	5	150.0	155.5	3	2517	60	—	80	116	17.5	45	17.5	—
SPA160-05	5	160.0	165.5	3	2517	60	—	80	126	17.5	45	17.5	—
SPA180-05	5	180.0	185.5	3	3020	75	—	80	146	14.5	51	14.5	—
SPA200-05	5	200.0	205.5	3	3020	75	—	80	165	14.5	51	14.5	—
SPA224-05	5	224.0	229.5	2	3020	75	—	80	189	—	51	29	—
SPA250-05	5	250.0	255.5	6	3020	75	10	80	215	14.5	51	14.5	150
SPA280-05	5	280.0	285.5	7	3535	90	10	80	245	4.5	89	4.5	170
SPA315-05	5	315.0	320.5	7	3535	90	12	80	280	4.5	89	4.5	170
SPA355-05	5	355.0	360.5	4	3535	90	—	80	320	4.5	89	4.5	170
SPA400-05	5	400.0	405.5	4	3535	90	—	80	365	4.5	89	4.5	170
SPA450-05	5	450.0	455.5	4	3535	90	—	80	415	4.5	89	4.5	170
SPA500-05	5	500.0	505.5	4	3535	90	—	80	465	4.5	89	4.5	170
SPA560-05	5	560.0	565.5	4	3535	90	—	80	525	4.5	89	4.5	170
SPA630-05	5	630.0	635.5	4	3535	90	—	80	595	4.5	89	4.5	170
SPA800-05	5	800.0	805.5	4	4040	100	—	80	765	11	102	11	216
SPA1000-05	5	1000.0	1005.5	4	4545	110	—	80	965	17	114	17	225

Taper Bore V-pulleys

SPA-6

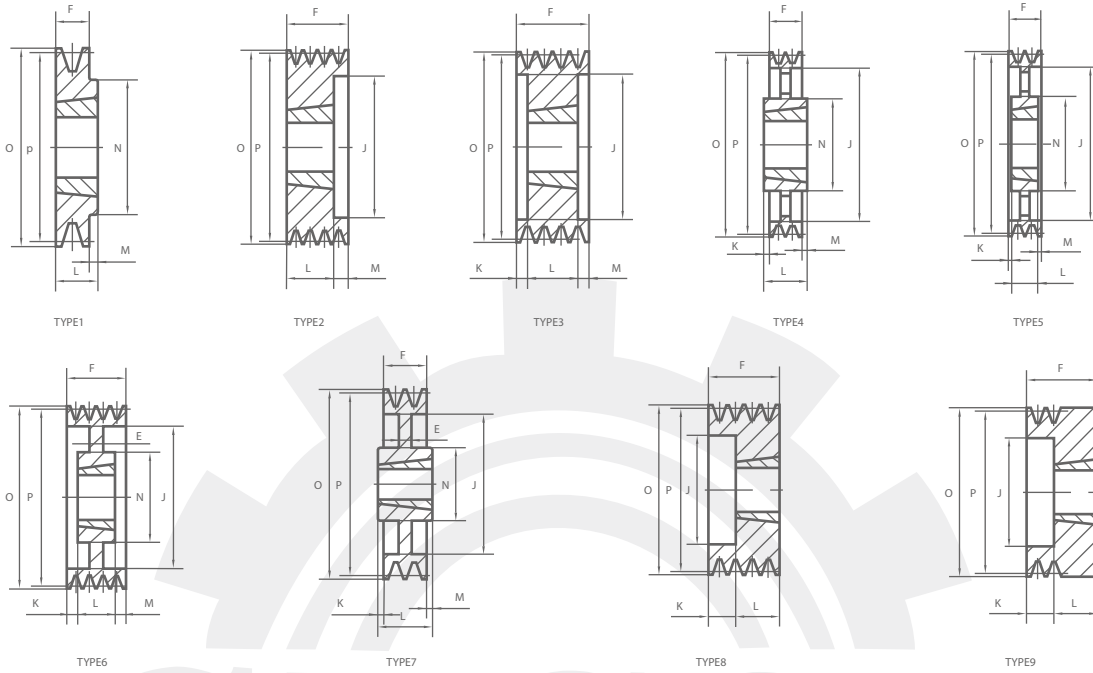

PART NO.	NO.OF P.D GROOVES	O.D	TYPE	BUSH	MAX NO.	E BORE	F	J	K	L	M	N	
SPA100-06	6	100.0	105.5	3	1615	42	—	95	70	28.5	38	28.5	—
SPA106-06	6	106.0	111.5	8	2012	50	—	95	76	63	32	—	—
SPA112-06	6	112.0	117.5	8	2012	50	—	95	80	63	32	—	—
SPA118-06	6	118.0	123.5	8	2012	50	—	95	86	63	32	—	—
SPA125-06	6	125.0	130.5	3	2012	50	—	95	92	31.5	32	31.5	—
SPA132-06	6	132.0	137.5	3	2517	60	—	95	98	25	45	25	—
SPA140-06	6	140.0	145.5	3	2517	60	—	95	106	25	45	25	—
SPA150-06	6	150.0	155.5	3	2517	60	—	95	116	25	45	25	—
SPA160-06	6	160.0	165.5	3	2517	60	—	95	126	25	45	25	—
SPA180-06	6	180.0	185.5	3	3020	75	—	95	146	22	51	22	—
SPA200-06	6	200.0	205.5	3	3020	75	—	95	165	22	51	22	—
SPA224-06	6	224.0	229.5	3	3020	75	—	95	189	22	51	22	—
SPA250-06	6	250.0	255.5	6	3020	75	20	95	215	22	51	22	150
SPA280-06	6	280.0	285.5	6	3535	90	25	95	245	3	89	3	170
SPA315-06	6	315.0	320.5	6	3535	90	25	95	280	3	89	3	170
SPA355-06	6	355.0	360.5	5	3535	90	—	95	320	3	89	3	170
SPA400-06	6	400.0	405.5	5	3535	90	—	95	365	3	89	3	170
SPA450-06	6	450.0	455.5	5	3535	90	—	95	415	3	89	3	170
SPA500-06	6	500.0	505.5	5	3535	90	—	95	465	3	89	3	170
SPA560-06	6	560.0	565.5	5	3535	90	—	95	525	3	89	3	170
SPA630-06	6	630.0	635.5	4	4040	100	—	95	595	3.5	102	3.5	216
SPA800-06	6	800.0	805.5	4	4040	100	—	95	765	3.5	102	3.5	216
SPA1000-06	6	1000.0	1005.5	4	4545	110	—	95	965	9.5	114	9.5	225